

Specifications & Dimensions
Type : EMA / EM

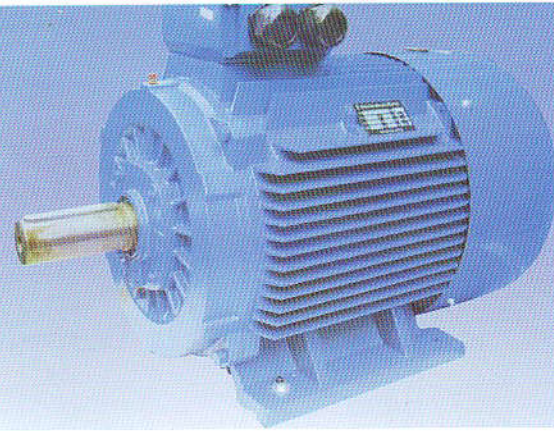

Elektrim Electric Motors

Totally enclosed fan-cooled (TEFC)
 three-phase motors with squirrel cage
 for low voltage, with antifriction bearings.

EMA Series (Aluminium Frames)

2 POLE - 3000 RPM SYNCHRONOUS SPEED AT 380V, 50Hz

Models	Power		Current at 380V (A)	Speed (r.p.m.)	Eff (%)	Power factor	Nominal Torque (Nm)	T _{start} T _n	T _{max} T _n	I _{st} I _n	Moment of inertia (kg m ²)	Weight (kg)
	HP	kW										
EMA631-2	1/4	0.18	0.53	2800	69	0.75	0.63	2.2	2.4	6	0.00013	5
EMA632-2	1/3	0.25	0.68	2800	72	0.78	0.88	2.2	2.4	6	0.00015	5.3
EMA711-2	1/2	0.37	0.95	2800	73.5	0.80	1.31	2.2	2.4	6	0.00044	6.5
EMA712-2	3/4	0.55	1.35	2800	75.5	0.82	1.93	2.2	2.4	6	0.00055	7
EMA801-2	1	0.75	1.75	2800	76.5	0.85	2.62	2.2	2.4	6	0.00068	9.5
EMA802-2	1.5	1.1	2.55	2800	77	0.85	3.83	2.2	2.4	6	0.00086	11
EMA90S-2	2	1.5	3.84	2800	77	0.85	5.28	2.2	2.4	6	0.00146	14.5
EMA90L-2	3	2.2	4.98	2800	78	0.86	7.58	2.2	2.4	6	0.00184	17
EMA100L-2	4	3.0	11.1	2870	82	0.87	9.98	2.2	2.3	7	0.00253	24.5
EMA112M-2	5.5	4.0	8.2	2890	85.5	0.87	13.22	2.2	2.3	7	0.00511	30
EMA132S1-2	7.5	5.5	11	2900	85.5	0.88	18.05	2.0	2.2	7	0.0978	42
EMA132S2-2	10	7.5	15	2900	86.2	0.88	24.70	2.0	2.2	7	0.01125	50
EMA160M1-2	15	11.0	21.3	2930	88	0.88	36.10	2.0	2.2	7	0.0377	85
EMA160M2-2	20	15.0	28.7	2930	89	0.89	49.23	2.0	2.2	7	0.0449	95
EMA160L-2	25	18.5	34.6	2930	90	0.90	60.71	2.0	2.2	7	0.055	105

4 POLE - 1500 RPM SYNCHRONOUS SPEED AT 380V, 50Hz

EMA632-4	1/4	0.18	0.65	1400	64	0.66	1.28	2.2	2.4	6	0.00028	5
EMA711-4	1/3	0.25	0.83	1400	67	0.68	1.72	2.2	2.4	6	0.00044	6.3
EMA712-4	1/2	0.37	1.12	1400	69.5	0.72	2.57	2.2	2.4	6	0.00054	7
EMA801-4	3/4	0.55	1.56	1400	73.5	0.73	3.83	2.2	2.4	6	0.0012	9.5
EMA802-4	1	0.75	2.01	1400	75.5	0.75	5.19	2.2	2.4	6	0.0015	11
EMA90S-4	1.5	1.1	2.75	1400	78	0.78	7.56	2.2	2.4	6	0.00177	14.5
EMA90L-4	2	1.5	3.65	1400	79	0.79	10.23	2.2	2.4	6	0.00228	16
EMA100L1-4	3	2.2	5.0	1430	81	0.82	14.69	2.2	2.3	7	0.00494	23
EMA100L2-4	4	3.0	6.8	1430	82.5	0.81	20.03	2.2	2.3	7	0.00612	27
EMA112M-4	5.5	4.0	8.8	1440	84.5	0.82	26.53	2.2	2.3	7	0.01064	33.5
EMA132S-4	7.5	5.5	12	1440	85.5	0.84	36.48	2.2	2.2	7	0.02818	49.5
EMA132M-4	10	7.5	15	1440	87	0.85	49.40	2.2	2.2	7	0.2833	57.5
EMA160M-4	15	11.0	22.3	1460	88	0.85	72.45	2.0	2.2	7	0.0747	90
EMA160L-4	20	15.0	30	1460	89	0.85	98.79	2.0	2.2	7	0.0918	100

6 POLE - 1000 RPM SYNCHRONOUS SPEED AT 380V, 50Hz

EMA71M-6	1/4	0.18	0.65	835	56	0.75	2.0	2.1	1.9	2.3	0.0006	6.3
EMA80M-6	1/2	0.37	1.25	920	62	0.72	3.9	1.9	2.1	3.1	0.0015	6.5
EMA90S-6	1	0.75	2.3	910	72.5	0.70	7.7	2.2	2.2	5.5	0.0026	14.5
EMA90L-6	1.5	1.1	3.2	910	73.5	0.72	11.30	2.2	2.2	5.5	0.0035	17
EMA100L-6	2	1.5	4.0	940	77.5	0.74	15.16	2.2	2.2	6	0.00563	22.5
EMA112M-6	3	2.2	5.6	940	80.5	0.74	22.23	2.2	2.2	6	0.01585	29
EMA132S-6	4	3.0	7.2	960	83	0.76	29.84	2.0	2.0	6.5	0.02586	48
EMA132M1-6	5.5	4.0	9.4	960	84	0.77	39.79	2.0	2.0	6.5	0.03088	49
EMA132M2-6	7.5	5.5	13	960	85.3	0.78	54.71	2.0	2.0	6.5	0.03611	57.5
EMA160M-6	10	7.5	16.5	970	86	0.80	74.61	2.0	2.0	6.5	0.0881	85
EMA160L-6	15	11.0	24.1	970	87.5	0.79	109.4	2.0	2.0	6.5	0.116	100

2 POLE - 3000 RPM SYNCHRONOUS SPEED AT 380V, 50Hz

Models	Power		Current at 380V (A)	Speed (r.p.m.)	Eff (%)	Power factor	Nominal Torque (Nm)	T _{start} T _n	T _{max} T _n	I _{st} I _n	Moment of inertia (kg m ²)	Weight (kg)
	HP	kW										
EMI160M1-2	15	11.0	21.3	2950	88	0.88	36.10	2.0	2.2	8.0	0.0377	85
EMI160M2-2	20	15.0	28.7	2970	89	0.89	49.23	2.0	2.2	8.0	0.0449	95
EMI160L-2	25	18.5	34.6	2970	90	0.90	60.71	2.0	2.2	8.0	0.055	105
EMI180M-2	30	22.0	40.9	2970	90.5	0.90	72.20	2.0	2.2	8.0	0.075	130
EMI200L1-2	40	30.0	55.4	2970	91.2	0.90	98.45	2.0	2.2	8.0	0.124	217
EMI200L2-2	50	37.0	67.7	2980	92	0.90	121.43	2.0	2.2	8.0	0.139	245
EMI225M-2	60	45.0	82.3	2980	92.3	0.90	147.68	1.8	2.2	8.0	0.233	310
EMI250M-2	75	55	101	2980	92.5	0.90	180.50	1.8	2.2	7.0	0.312	369
EMI280S-2	100	75	134	2980	93.0	0.90	246.13	1.8	2.2	7.0	0.597	500
EMI280M-2	125	90	160	2980	93.8	0.91	295.36	1.8	2.2	7.0	0.675	557
EMI315S-2	150	110	195	2980	94.0	0.91	361.00	1.8	2.2	6.8	1.18	960
EMI315M-2	175	132	233	2980	94.5	0.91	433.20	1.8	2.2	6.8	1.82	1060
EMI315L1-2	220	160	279	2980	94.6	0.92	525.09	1.8	2.2	6.8	2.08	1140
EMI315L2-2	270	200	348	2980	94.8	0.92	656.36	1.8	2.2	6.8	2.82	1190
EMI355M-2	335	250	433	2980	95.3	0.92	820.45	1.6	2.2	7.0	3.28	1740
EMI355L-2	420	315	544	2980	95.6	0.92	1033.76	1.6	2.2	7.1	4.10	1880

4 POLE - 1500 RPM SYNCHRONOUS SPEED AT 380V, 50Hz

EMI160M-4	15	11.0	22.3	1460	88	0.85	72.45	2.0	2.2	7.0	0.0747	90
EMI160L-4	20	15.0	30	1460	89	0.85	98.79	2.0	2.2	7.0	0.0918	100
EMI180M-4	25	18.5	36.4	1470	90.5	0.85	121.84	2.2	2.2	7.5	0.139	130
EMI180L-4	30	22.0	43.1	1470	91	0.85	144.90	2.2	2.2	7.5	0.158	140
EMI200L-4	40	30.0	57.4	1470	92	0.86	197.59	2.2	2.2	7.5	0.262	231
EMI225S-4	50	37.0	69.9	1480	92.5	0.87	243.69	2.2	2.2	7.5	0.406	290
EMI225M-4	60	45.0	84.7	1480	92.8	0.87	296.38	2.2	2.2	7.5	0.469	320
EMI250M-4	75	55	103	1480	93.0	0.89	362.24	2.2	2.2	7.0	0.66	380
EMI280S-4	100	75	140	1480	93.8	0.86	493.97	2.2	2.2	7.0	1.12	526
EMI280M-4	125	90	167	1490	94.2	0.86	592.76	2.2	2.2	7.0	1.46	600
EMI315S-4	150	110	201	1490	94.5	0.87	724.48	2.1	2.2	6.9	3.11	980
EMI315M-4	175	132	240	1490	94.8	0.87	869.38	2.1	2.2	6.9	3.62	1080
EMI315L1-4	220	160	287	1490	94.9	0.88	1053.79	2.1	2.2	6.9	4.13	1120
EMI315L2-4	270	200	359	1490	95.0	0.88	1317.24	2.3	2.2	6.9	4.82	1170
EMI355M-4	335	250	443	1485	95.3	0.88	1646.55	2.3	2.2	6.8	5.21	1780
EMI355L-4	420	315	556	1485	95.6	0.89	2074.66	2.2	2.2	6.9	5.40	1920

6 POLE - 1000 RPM SYNCHRONOUS SPEED AT 380V, 50Hz

EMI160M-6	10	7.5	16.5	970	86	0.80	74.61	2.0	2.0	6.5	0.0881	85
EMI160L-6	15	11.0	24.1	970	87.5	0.79	109.43	2.0	2.0	6.5	0.116	100
EMI180L-6	20	15.0	31.5	970	89	0.81	149.22	2.0	2.0	7.0	0.207	130
EMI200L1-6	25	18.5	38.5	970	90	0.81	184.04	2.0	2.0	7.0	0.315	205
EMI200L2-6	30	22.0	44.6	970	90	0.83	218.85	2.0	2.0	7.0	0.36	225
EMI225M-6	40	30.0	59.3	980	91.5	0.84	298.44	2.0	2.1	7.0	0.547	284
EMI250M-6	50	37.0	71.0	980	92.0	0.86	368.07	2.0	2.1	7.0	0.66	370
EMI280S-6	60	45.0	86.0	980	92.5	0.86	447.66	2.0	2.0	7.0	1.39	486
EMI280M-6	75	55	105	980	92.8	0.86	547.14	2.0	2.0	7.0	1.65	533
EMI315S-6	100	75	141	990	93.5	0.86	746.09	2.0	2.0	7.0	4.11	970
EMI315M-6	125	90	169	990	93.8	0.86	895.31	2.0	2.0	7.0	4.78	1060
EMI315L1-6	150	110	206	990	94.0	0.86	1094.27	2.0	2.0	6.7	5.45	1130
EMI315L2-6	175	132	244	990	94.2	0.87	1313.13	2.0	2.0	6.7	6.12	1190
EMI355M1-6	220	160	292	990	94.5	0.88	1591.67	1.9	2.0	6.7	6.50	1600
EMI355M2-6	270	200	365	990	94.7	0.88	1989.58	1.9	2.0	6.7	8.10	1730
EMI355L-6	335	250	455	990	94.9	0.88	2486.98	1.9	2.0	6.7	8.25	1980



EMA, B3, Foot-Mounted, F100L



EMA, B5, Flange-Mounted, F132M

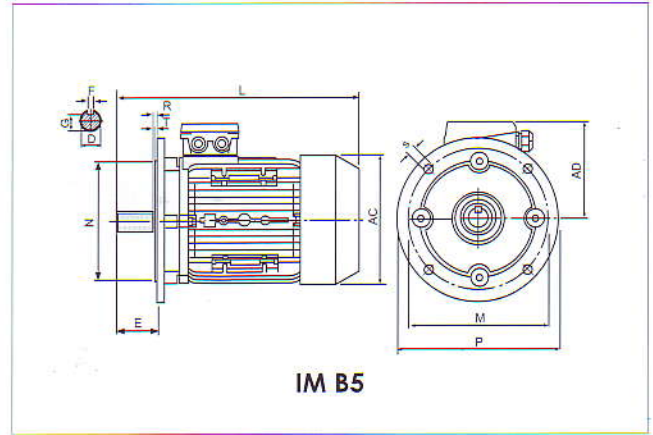
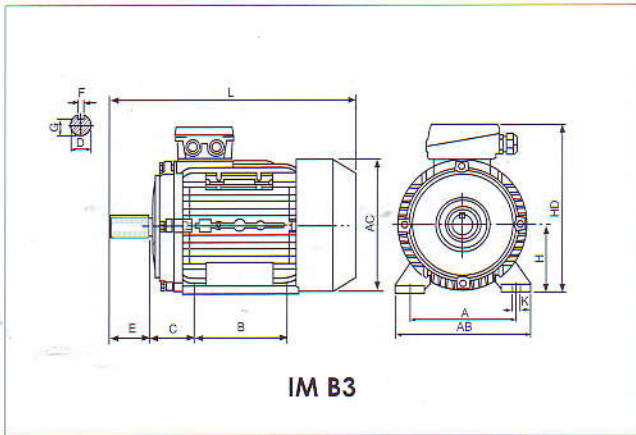

Frame Sizes	Mounting Dimensions (mm)															DIMENSIONS (mm)				
																Frame Dimensions (mm)				
	IMB3							IMB5								AB	AC	AD	HD	L
	A	B	C	D	E	F	G	H	K	M	N	P	R	S	T					
56	90	71	36	9	20	3	7.2	56	5.8	98	80	120	0	7	3.0	110	120	110	155	195
63	100	80	40	11	23	4	8.5	63	7	115	95	140	0	10	3.0	130	130	115	165	230
71	112	90	45	14	30	5	11	71	7	130	110	160	0	10	3.5	145	145	125	185	255
80	125	100	50	19	40	6	15.5	80	10	165	130	200	0	12	3.5	160	165	135	215	295
90S	140	100	56	24	50	8	20	90	10	165	130	200	0	12	3.5	180	185	145	235	335
90L	140	125	56	24	50	8	20	90	10	165	130	200	0	12	3.5	180	185	145	235	360
100L	160	140	63	28	60	8	24	100	12	215	180	250	0	15	4.0	205	215	170	255	380
112M	190	140	70	28	60	8	24	112	12	215	180	250	0	15	4.0	245	240	180	285	400
132S	216	140	89	38	80	10	33	132	12	265	230	300	0	15	4.0	280	275	195	325	475
132M	216	178	89	38	80	10	33	132	12	265	230	300	0	15	4.0	280	275	195	325	515
160M	254	210	108	43	110	12	37	160	15	300	250	350	0	15	5.0	320	330	255	420	615
160L	254	254	108	42	110	12	37	160	15	300	250	350	0	15	5.0	320	330	255	420	670

Parts of A Standard ELEKTRIM ELECTRIC MOTORS

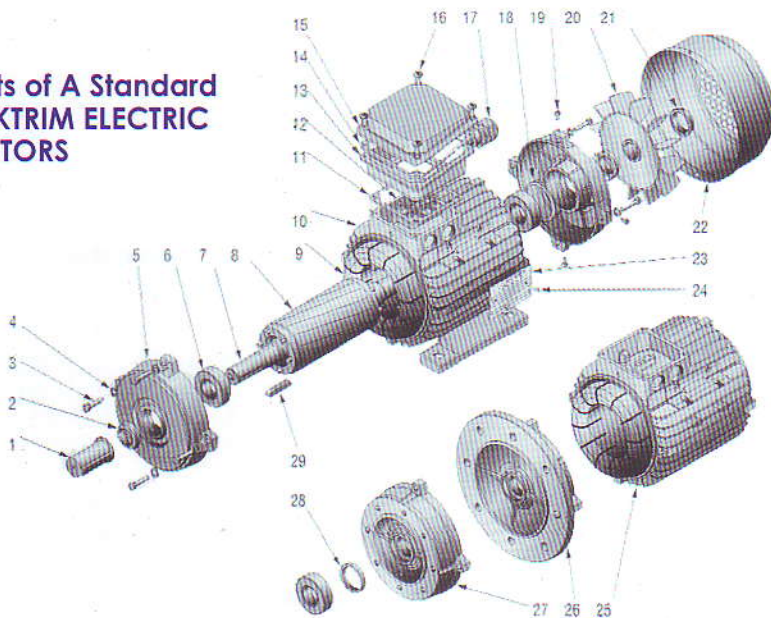

No. Description

1. Shaft Cover
2. V-ring
3. Clamping screws
4. Washer
5. End shield (bracket)
6. Bearing
7. Motor shaft
8. Rotor
9. Wound stator
10. B3 motor frame
11. IP 55 gasket
12. Terminal block
13. Terminal box base
14. Gasket
15. Terminal box cover
16. Terminal box tightening screws
17. Cable inlet bush
18. Compensation spring
19. Fan cover tightening screws
20. PVC fan
21. Ring for fan tightening
22. Fan cover
23. Motor name plate
24. Name plate tightening screws
25. B5 motor frame
26. B5 flange
27. B14 flange
28. Sealing ring
29. Shaft key

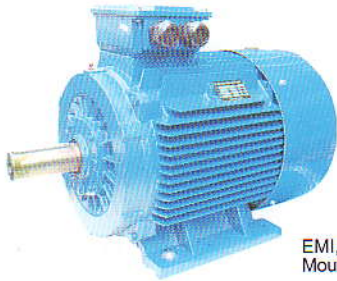

EMI, B3, Foot-Mounted, F225M

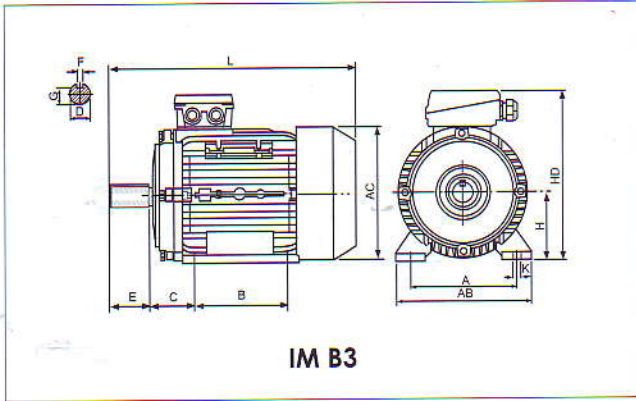

IM B3

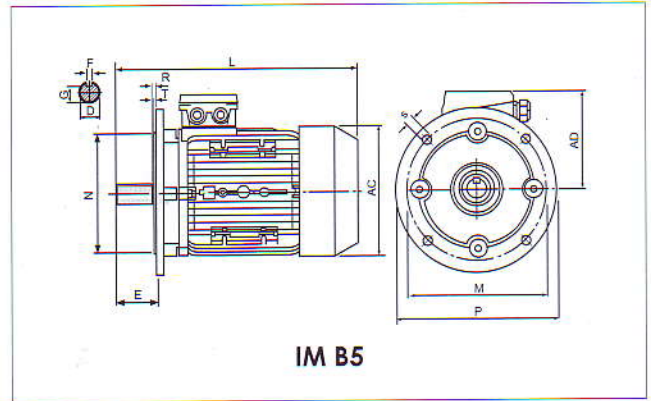

IM B5

DIMENSIONS (mm)

Frame Sizes	Mounting Dimensions (mm)												
	A	B	C	D		E		F		G		H	K
				2P	4,6,8	2P	4,6,8	2P	4,6,8	2P	4,6,8		
160M	254	210	108	42	110	12	37	160	15				
160L	254	254	108	42	110	12	37	160	15				
180M	279	241	121	48	110	14	42.5	180	15				
180L	279	279	121	48	110	14	42.5	180	15				
200L	318	305	133	55	110	16	49	200	19				
225S	356	286	149	-	60	-	18	-	53	225	19		
225M	356	311	149	55	60	110	140	16	18	49	53	225	19
250M	406	349	168	60	65	140	18	18	53	58	250	24	
280S	457	368	190	65	75	140	18	20	58	67.5	280	24	
280M	457	419	190	65	75	140	18	20	58	67.5	280	24	
315S	508	406	216	65	80	140	170	18	22	58	71	315	28
315M	508	457	216	65	80	140	170	18	22	58	71	315	28
315L	508	508	216	65	80	140	170	18	22	58	71	315	28
355M	610	560	254	75	95	140	170	20	25	67.5	86	355	28
355L	610	630	254	75	95	140	170	20	25	67.5	86	355	28

DIMENSIONS (mm)

Frame Sizes	Mounting Dimensions (mm)												
	A	B	C	D		E		F		G		H	K
				2P	4,6,8	2P	4,6,8	2P	4,6,8	2P	4,6,8		
160M	300	250	350	0	19	5	320	330	255	420	615		
160L	300	250	350	0	19	5	320	330	255	420	670		
180M	300	250	350	0	19	5	355	380	280	455	700		
180L	300	250	350	0	19	5	355	380	280	455	740		
200L	350	300	400	0	19	5	395	420	305	505	770		
225S	400	350	450	0	19	5	435	470	335	560	-	820	
225M	400	350	450	0	19	5	435	470	335	560	815	845	
250M	500	450	550	0	19	5	490	510	370	615	910		
280S	500	450	550	0	19	5	550	580	410	680	985		
280M	500	450	550	0	19	5	550	580	410	680	1035		
315S	600	550	660	0	24	6	635	645	630	845	1185	1215	
315M	600	550	660	0	24	6	635	645	630	845	1295	1325	
315L	600	550	660	0	24	6	635	645	630	845	1295	1325	
355M	740	680	800	0	24	6	730	710	655	1010	1500	1530	
355L	740	680	800	0	24	6	730	710	655	1010	1500	1530	